

ELMO

TND4204VX

Vandal resistant type

High-Resolution DSP Color Dome Camera



High-Resolution, High Sensitivity, Heavy Duty Color Dome camera
For sophisticated security system, suitable especially for use
in low light conditions.

- Rugged aluminum diecast body & polycarbonate bubble
- 480TVL Horizontal Resolution
- Dual power capability 24V AC / 12V DC
- Flicker correction setting
- Minimum illumination requirement 0.35lx (F1.2)
- Full Digital Signal Processing
- Easy to install (Integrator Friendly)

ELMO

Visualizing technology since 1921

Vandal resistant type

High-Resolution DSP Color Dome Camera **TND4204VX**

TND4204VX SPECIFICATIONS

Model	TND4204VX(Vandal resistant type camera)
Power source	AC24V(AC15V-27V) 60Hz±0.5Hz or DC12V(DC11V-35V)
Power consumption	AC : Approx.2.5W or DC : Approx.2.8W
Image pick-up device	1/3" color interline-transfer CCD
Effective picture element	768(H) x 494(V)
Scanning area	4.88mm(H) x 3.66mm(V)
Scanning system	2:1 Interlaced
Scanning frequency	LL : 15.75kHz(H),60Hz(V) INT : 15.734kHz(H),59.94Hz(V)
Sync.system	AC : Line-lock/Internal (switchable) DC : Internal
Resolution	480TV lines(H), 350TV lines(V)
S/N ratio	50dB
Standard illumination	60lx (F1.2 under incandescent lamp)
Lowest illumination	0.35lx (F1.2 under incandescent lamp)
White balance	ATW/PUSH (switchable)
AGC	Built-in (SENS UP switchable)
Backlight control (BLC)	Provided (switchable)
Electronic shutter	1/60sec. / 1/100sec. (switchable)
Power	Power cable (Non-plug)
Video out	BNC cable output VBS 1.0v(p-p) 75Ω
Lens	Varifocal lens F1.2 f=3~9mm
Angle of view	Horizontal 31.8°(Tele) ~ 90.0°(Wide) Vertical 23.9°(Tele) ~ 68.2°(Wide)
Movable angle	Pan 180°(±90°) / Tilt 120°(±60°) / Camera 290°
Waterproof rating	IP66
Dimensions	Diameter : 166mm (6.54") Height : 128mm (5.04")
Weight	Approx.1600g (3.52lbs)
Ambient temperature	-10°C ~ +50°C (14°F ~ 122°F)
Ambient humidity	30 ~ 90%
Accessories	Instruction manual, Dedicated wrench

NOTE: *Design and specifications are subject to change without prior notice.
*Dimensions and weight are approximate.



PROFILE

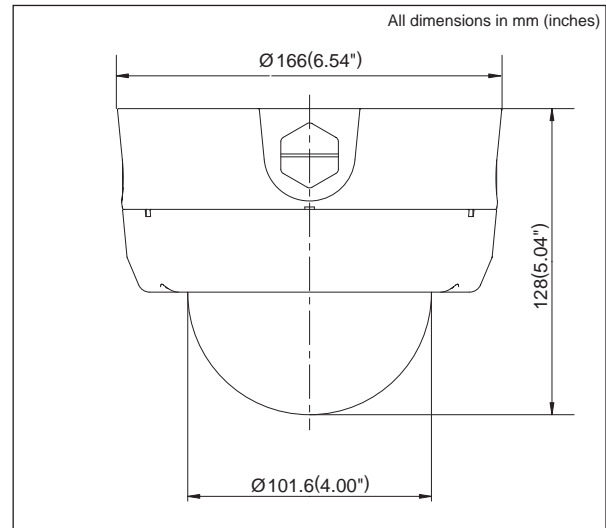

ELMO CO.,LTD.(Head Office and Factory)'s QMS/EMS has been registered to ISO 9001 & ISO 14001.

ELMO® ELMO CO., LTD.

Additional technical information is available from any of the following subsidiary companies;

ELMO and **ELMO** are registered trademarks of ELMO COMPANY, LIMITED.



This brochure is printed on recycled paper with soy ink.
Printed in Japan(S)06/2004