



Shutter Module, A08390, shown attached to an ACE® Light Source. Also shown is the power supply, A08396.

Shutter Module*

Part No.	Blade Option / Description
Without Iris Diaphragm	
A08390	Standard
A08390.1	A. Alternating illumination between two sections of special-order, dual configurations.
A08390.2	B. Alternating colors. Filters are not included but can be purchased separately.
With Iris Diaphragm	
A08391	Standard
A08391.1	A. Alternating illumination between two sections of special-order, dual configurations.
A08391.2	B. Alternating colors. Filters are not included but can be purchased separately.
Accessory	
A08394	Footswitch
Power Supply	
A08396	Power Supply, 24 VDC, 400 mA, 115 VAC Input Only

* Lamp, Power Supply, and Footswitch are not included with Shutter Module.

Shutter Module

For interrupting or altering light transmittance without turning the light source on and off.

Standard Features

- For use with DCR® series and ACE® series light sources.
- On/Off and momentary Off/On remote switch with a 6' cable and a 24 VDC, 2.5 mm diameter input jack.
- Maximum speed is 2 cycles per second.
- Shutter blade is operated by a 24 volt, DC 225mA continuous solenoid.
- External power supply is required and offered as an option, part number A08396.
- Standard shutter blade is on/off configuration. Two other blade options can be used and should be specified when ordering. See chart on left for corresponding part numbers and drawing diagrams on back side of page for more details.
 - A. Alternating illumination between two sections of fiber configurations in a dual assembly.
 - B. Alternating colors. Filters are not included but can be purchased separately.
- Optional footswitch to activate shutter, part number A08394.
- Shutter module includes a complete Modulamp® assembly, but does not include the lamp, footswitch, or power supply. These items must be ordered separately.
- Manufactured in the USA.

Ordering Instructions

- Shutter Module with Light Source:
 - A08390* or A08391*
 - Power Supply of your choice: A 20500.115 or A20510.230, DCR III A20801, DCR III Remote Kit A2085 or A20570.230, ACE Remote
 - Lamp of your choice
- Shutter Module Only:
 - A08390* without Iris Diaphragm or A08391* with Iris Diaphragm
 - Lamp of your choice

* If standard shutter blade is not required, indicate blade option A (A08390.1 / A08391.1) or B (A08390.2 / A08391.2)

Shutter Module

Dimensions in () are in mm

TECHNICAL SPECIFICATIONS

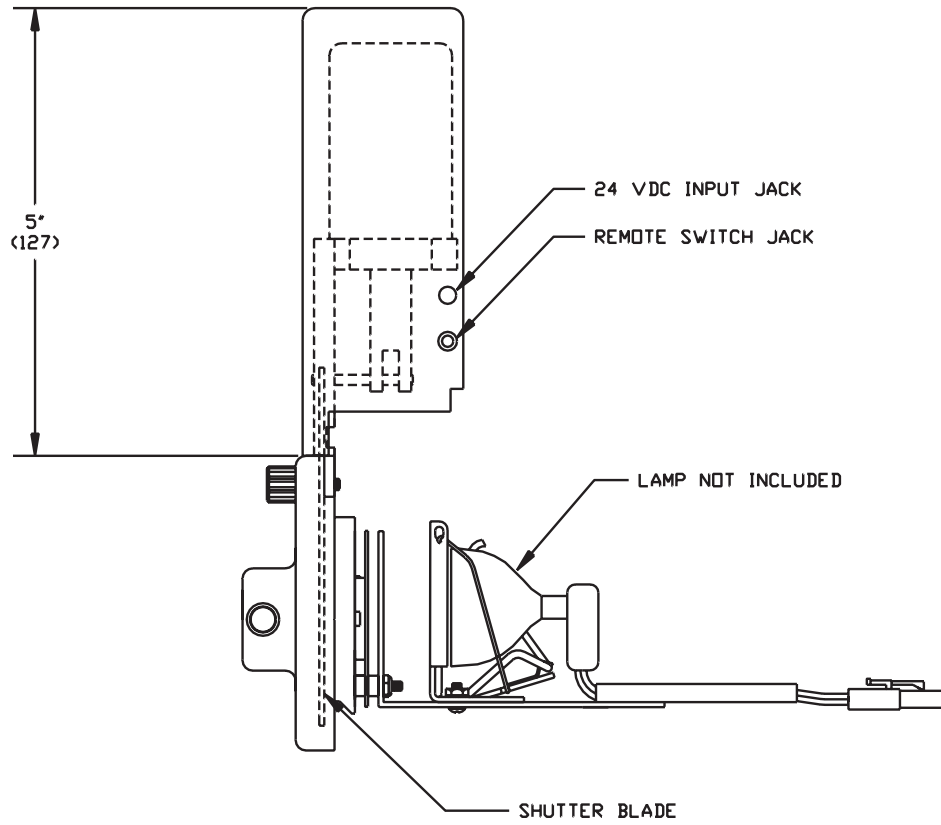

Shutter Blade Options - Standard, A and B

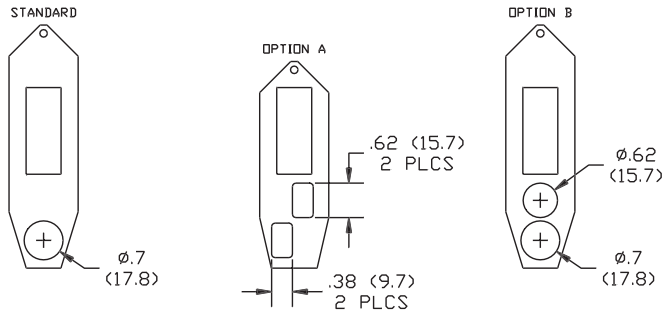

A08394 - Footswitch

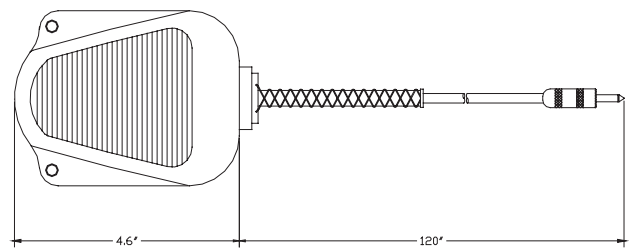

SCHOTT